



PR 
PROPERTY

64 Dunstable Road, Toddington, Bedfordshire, LU5 6DR
£1,100 PCM

- CHARACTER COTTAGE
- MUST BE VIEWED
- LOCATED IN VILLAGE OF TODDINGTON

- TWO DOUBLE BEDROOMS
- EASY PARKING AVAILABLE
- CLOSE TO M1 TRAVEL LINKS

- PRIVATE REAR GARDEN
- AVAILABLE LATE JANUARY 2026
- WALKING DISTANCE TO LOCAL VILLAGE AMENITIES

**** P&R PROPERTY LETTINGS **** AN ATTRACTIVE TWO BEDROOM COTTAGE *** VILLAGE OF TODDINGTON *** AVAILABLE LATE JANUARY 2026 *** GAS CENTRAL HEATING *** CLOSE TO M1 TRAVEL LINKS *** PRIVATE REAR GARDEN *** CLOSE TO LOCAL VILLAGE AMENITIES *** GOOD CONDITION *** TWO DOUBLE BEDROOMS *** MUST BE VIEWED ***

LOUNGE 11'7" X 10'8" (3.54 X 3.25)

KITCHEN/DINER 11'7" X 10'0" (3.54 X 3.05)

BATHROOM

BEDROOM 1 11'7" X 10'8" (3.54 X 3.25)

BEDROOM 2 10'0" X 8'8" (3.05 X 2.64)

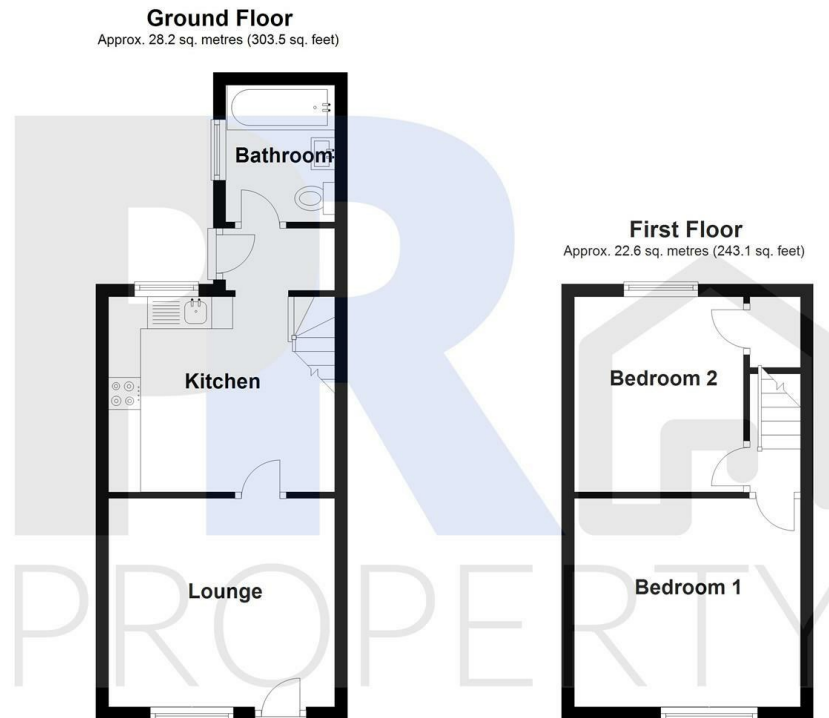

Total area: approx. 50.8 sq. metres (546.6 sq. feet)

64 Dunstable Road

Energy Efficiency Rating		Current	Potential
Very energy efficient - lower running costs			
(92 plus)	A		87
(81-91)	B		
(69-80)	C		
(55-68)	D	68	
(39-54)	E		
(21-38)	F		
(1-20)	G		
Not energy efficient - higher running costs			
England & Wales		EU Directive 2002/91/EC	